

872
0007

FIRST AMENDMENT TO SPECIAL DISTRICT PUBLIC DISCLOSURE DOCUMENT

ABILENE STATION METROPOLITAN DISTRICT NO. 1

As required pursuant to Section 32-1-104.8 of the Colorado Revised Statutes (“C.R.S.”), Abilene Station Metropolitan District No. 1 (“**District**”) recorded its Public Disclosure Document on January 9, 2015 in the real property records of Arapahoe County, Colorado at Reception Number D5002477 (“**Public Disclosure Document**”).

The District has changed its boundaries pursuant to Section 32-1-401, *et. seq.*, C.R.S. and/or Section 32-1-501, *et. seq.*, C.R.S.

Exhibit A to the Public Disclosure Document is hereby deleted in its entirety, and substituted in lieu thereof shall be **Exhibit 1**, an updated boundary map of the District, attached hereto and incorporated herein.

Dated this 27th day of April, 2017.

EXHIBIT 1

Updated District Map

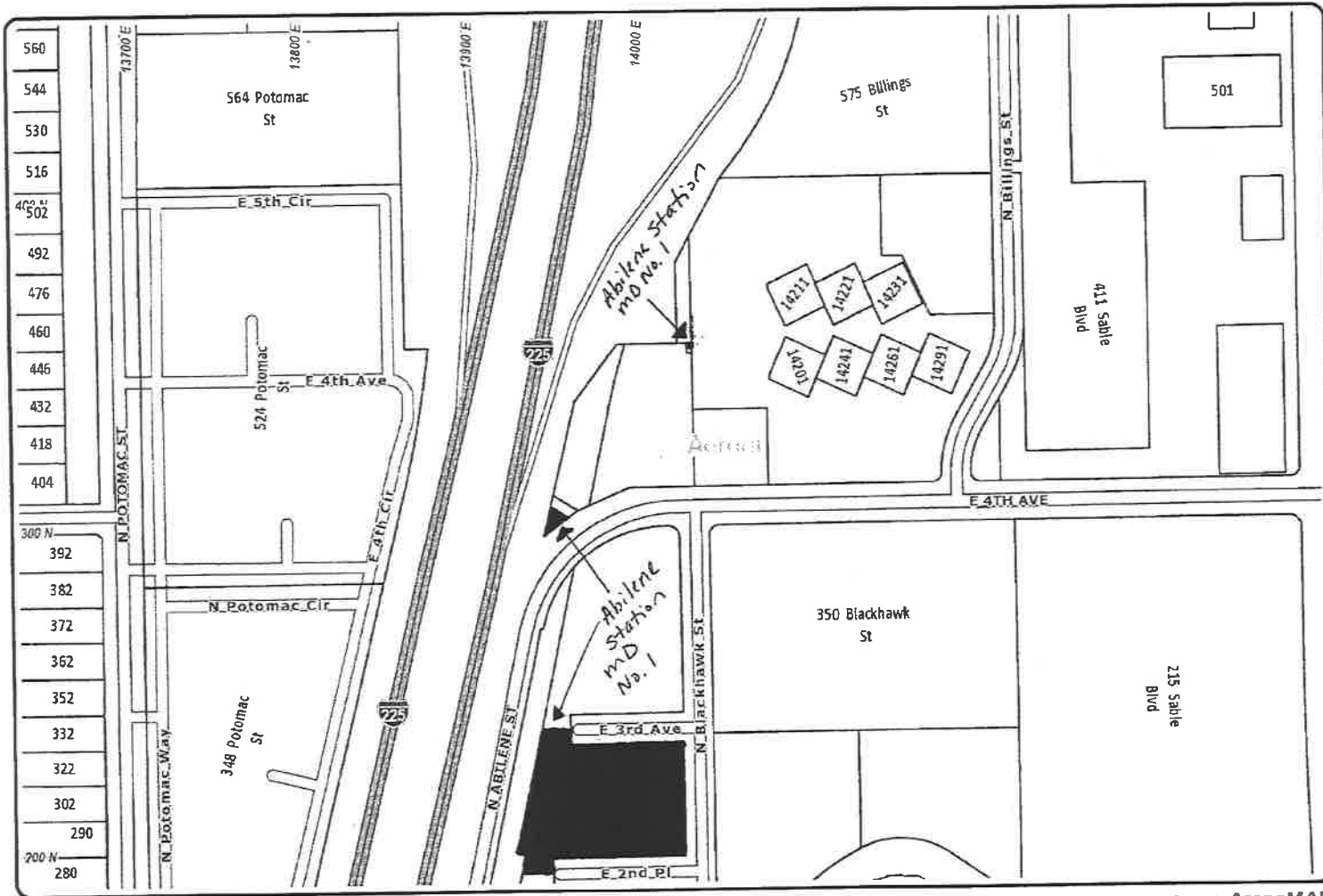

Abilene Station MD No. 1



ARAPAHOE COUNTY MAKES NO REPRESENTATION OR WARRANTY AS TO THE ACCURACY OF THIS MAP OR THE DATA THAT IT DISPLAYS. ARAPAHOE COUNTY ASSUMES NO RESPONSIBILITY OR LIABILITY TO ANY USER. THIS MAP IS NOT A LEGAL DOCUMENT. IT IS INTENDED TO SERVE AS AN AID IN GRAPHIC REPRESENTATION ONLY.

Map Generated On: 4/26/2017

Generated by Arapahoe County's ArapaMAP

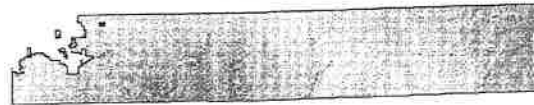

Map Location